

The West Quarter

Bournemouth, Dorset

The West Quarter is an exciting, contemporary development of mews houses, and apartments which includes two office suites in a courtyard setting ideally located close to the retail, business and leisure heart of Bournemouth.

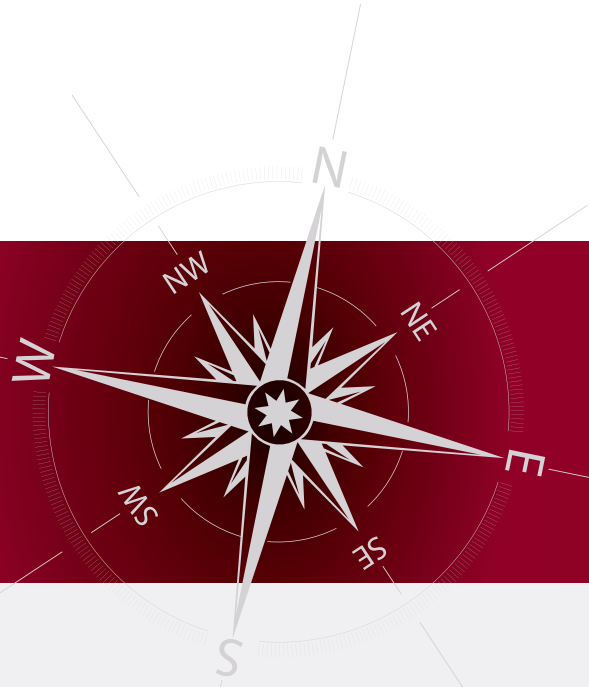

If you are looking for a small office suite the West Quarter office development provides you with brand new, purpose built offices, in the heart of Bournemouth.



The office suites are set in a courtyard and are glass fronted making the most of the available natural light. The suites are self-contained with total area approximately 500 sq ft and 400 sq ft. Entrance to one is from Poole Hill and the second from West Hill Road.

They have been finished to an extremely high specification with meticulous attention to detail:

Kitchen and Cloakroom

- Kitchenette with gloss white finish units with tiling above, water heater, sink and fridge
- Cloakroom with brilliant white sanitary ware with monoblock taps in polished chrome

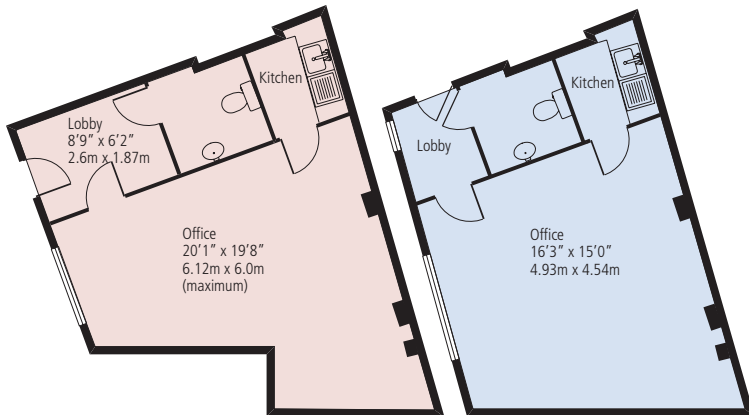

The West Quarter can be found off Poole Hill and West Hill Road in the centre of Bournemouth.

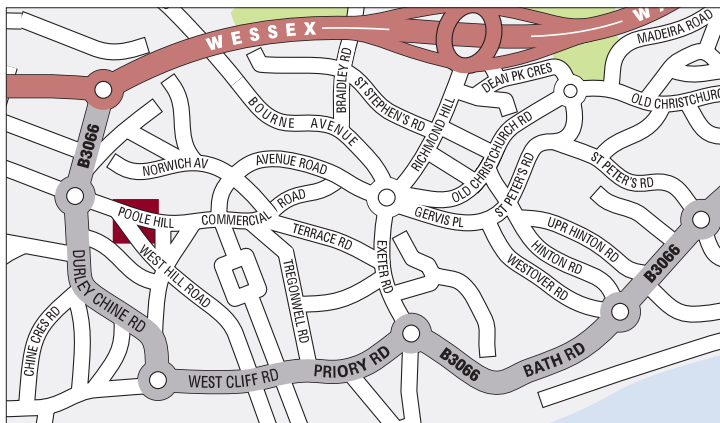

Internal Finish

- Heavy duty commercial carpeting throughout
- Smooth finish to walls with coving throughout
- Chrome door furniture
- Electric storage heating
- BT points
- Entry phone system
- Double glazed sealed units throughout
- Concealed down lights

External

- Cycle and bin store in rear courtyard
- There are no allocated parking spaces for The West Quarter office suite. There is on street parking close by and parking permits for the West Hill public car park are available from the Council.



All work has been carried out by Sanctuary Construction Limited, the building arm of Angerwich Property Group, which is staffed by professional personnel who have a considerable amount of experience in the building and construction industry. Sanctuary Construction is a member of the Guild of Builders and Contractors and is covered by the BLP scheme which provides New Home Warranties and buildings defects insurance. BLP is recognised by the Council of Mortgage Lenders.



This brochure is intended to give a general indication of the proposed development and is believed to be correct at the time of printing. Angerwich Properties reserve the right to make any changes thought necessary to the development and individual specifications at any time. The contents of this brochure do not constitute an offer or form any contract or an inducement for any such contract. No responsibility is taken for any error, omission or mis-statement in the brochure. No representation or warranty whatsoever is made or given in relation to these particulars, with the agents or the developers, during negotiations or otherwise.

All photography courtesy of Bournemouth Tourism.

